

Insert Ball Bearings

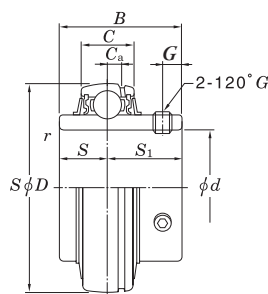

UC 200

Inch series



d $1/2 \sim 3 1/2$ inch

Bearing No.	Shaft dia inch	Boundary dimensions mm								Basic load ratings				Mass kg (approx.)		
		d	D	B	C	r	S	S_1	G	$d_s(UNF)$	C_a	d_4	C_r kN		C_{or} static	C_r dynamic
UC202-8	1/2	1.8504	1.2200	0.6690	0.0390	0.5000	0.7200	0.1770	1/4-28	0.1770	1.1420	12.8	6.6	1,300	670	0.21
UC202-10	5/8	1.8504	1.2200	0.6690	0.0390	0.5000	0.7200	0.1770	1/4-28	0.1770	1.1420	12.8	6.6	1,300	670	0.19
UC203-11	11/16	1.8504	1.2200	0.6690	0.0390	0.5000	0.7200	0.1770	1/4-28	0.1770	1.1420	12.8	6.6	1,300	670	0.18
UC204-12	3/4	1.8504	1.2200	0.6690	0.0590	0.5000	0.7200	0.1770	1/4-28	0.1770	1.1420	12.8	6.6	1,300	670	0.16
UC205-14	7/8	2.0472	1.3420	0.6690	0.0590	0.5630	0.7800	0.1970	1/4-28	0.1770	1.3390	14.0	7.9	1,420	800	0.19
UC205-16	1	2.0472	1.3420	0.6690	0.0590	0.5630	0.7800	0.1970	1/4-28	0.1770	1.3390	14.0	7.9	1,420	800	0.19
UC206-18	1 1/8	2.4409	1.5000	0.7480	0.0590	0.6260	0.8740	0.1970	1/4-28	0.2010	1.5940	19.6	11.3	2,000	1,150	0.31
UC206-19	1 3/16	2.4409	1.5000	0.7480	0.0590	0.6260	0.8740	0.1970	1/4-28	0.2010	1.5940	19.6	11.3	2,000	1,150	0.31
UC207-20	1 1/4	2.8346	1.6890	0.7870	0.0790	0.6890	1.0000	0.2360	5/16-24	0.2280	1.8900	25.9	15.4	2,640	1,550	0.48
UC207-21	1 5/16	2.8346	1.6890	0.7870	0.0790	0.6890	1.0000	0.2360	5/16-24	0.2280	1.8900	25.9	15.4	2,640	1,550	0.48
UC207-22	1 3/8	2.8346	1.6890	0.7870	0.0790	0.6890	1.0000	0.2360	5/16-24	0.2280	1.8900	25.9	15.4	2,640	1,550	0.48
UC207-23	1 7/16	2.8346	1.6890	0.7870	0.0790	0.6890	1.0000	0.2360	5/16-24	0.2280	1.8900	25.9	15.4	2,640	1,550	0.48
UC208-24	1 1/2	3.1496	1.9370	0.8270	0.0790	0.7480	1.1890	0.3150	5/16-24	0.2440	2.0870	29.3	17.9	2,980	1,820	0.62
UC209-26	1 5/8	3.3465	1.9370	0.8660	0.0790	0.7480	1.1890	0.3150	5/16-24	0.2560	2.2560	33.0	20.5	3,350	2,090	0.67
UC209-27	1 11/16	3.3465	1.9370	0.8660	0.0790	0.7480	1.1890	0.3150	5/16-24	0.2560	2.2560	33.0	20.5	3,350	2,090	0.67
UC209-28	1 3/4	3.3465	1.9370	0.8660	0.0790	0.7480	1.1890	0.3150	5/16-24	0.2560	2.2560	33.0	20.5	3,350	2,090	0.67
UC210-30	1 7/8	3.5433	2.0310	0.9060	0.0790	0.7480	1.2830	0.3540	3/8-24	0.2560	2.4800	35.5	23.2	3,600	2,360	0.78
UC210-31	1 15/16	3.5433	2.0310	0.9060	0.0790	0.7480	1.2830	0.3540	3/8-24	0.2560	2.4800	35.5	23.2	3,600	2,360	0.78
UC211-32	2	3.9370	2.1890	0.9450	0.0980	0.8740	1.3150	0.3540	3/8-24	0.2870	2.7560	43.0	29.4	4,350	3,000	1.03
UC211-35	2 3/16	3.9370	2.1890	0.9450	0.0980	0.8740	1.3150	0.3540	3/8-24	0.2870	2.7560	43.0	29.4	4,350	3,000	1.03
UC212-36	2 1/4	4.3307	2.5630	1.0240	0.0980	1.0000	1.5630	0.3940	3/8-24	0.3030	3.0310	52.5	36.1	5,350	3,680	1.45
UC212-38	2 3/8	4.3307	2.5630	1.0240	0.0980	1.0000	1.5630	0.3940	3/8-24	0.3030	3.0310	52.5	36.1	5,350	3,680	1.45
UC212-39	2 7/16	4.3307	2.5630	1.0240	0.0980	1.0000	1.5630	0.3940	3/8-24	0.3030	3.0310	52.5	36.1	5,350	3,680	1.45
UC213-40	2 1/2	4.7244	2.5630	1.0630	0.0980	1.0000	1.5630	0.3940	3/8-24	0.3270	3.2320	57.5	40.0	5,850	4,080	1.71
UC214-44	2 3/4	4.9213	2.9370	1.1420	0.0980	1.1890	1.7480	0.4720	7/16-20	0.3430	3.4250	62.0	44.0	6,300	4,480	2.06
UC215-48	3	5.1181	3.0630	1.1810	0.0980	1.3110	1.7520	0.5510	7/16-20	0.3620	3.6020	66.0	48.2	6,700	4,910	2.22
UC216-50	3 1/8	5.5118	3.2520	1.2600	0.1180	1.3110	1.9410	0.5510	7/16-20	0.3780	3.8780	72.5	53.0	7,400	5,400	2.82
UC217-52	3 1/4	5.9055	3.3740	1.3390	0.1180	1.3430	2.0310	0.5510	7/16-20	0.4130	4.1340	83.5	61.8	8,500	6,300	3.38
UC218-56	3 1/2	6.2992	3.7800	1.4170	0.1180	1.5630	2.2170	0.5910	1/2-20	0.4370	4.3900	95.5	71.4	9,750	7,280	4.34